

Installing Symantec Endpoint Protection on Windows 10

Determine what version of the client you will need to install (32 or 64 bit):

Click on the Search or Cortana to the right of the START button, examples:



Type **SYSTEM** into the search field and click on System from the list provided

In the **SYSTEM** window, look for the following section:

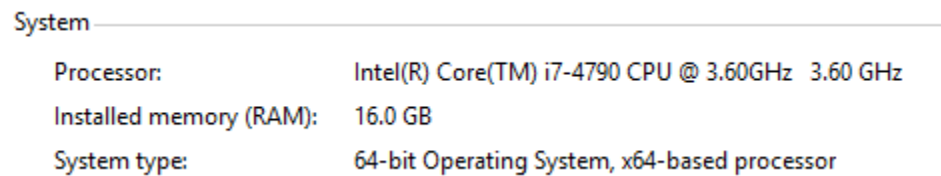

You will see either a 64 or 32 bit OS listed, which determines which version of SEP you will install on your computer.

Choose the correct version of the SEP installer, 32 or 64 bit. Both are located at:

<ftp://ftp.uaex.edu/IT/Symantec%20Endpoint%20Protection%20Clients/PC%20Clients/Visual/>

Download the setup.exe in that folder. Once it's saved, run the setup file. You will see the following option screens:

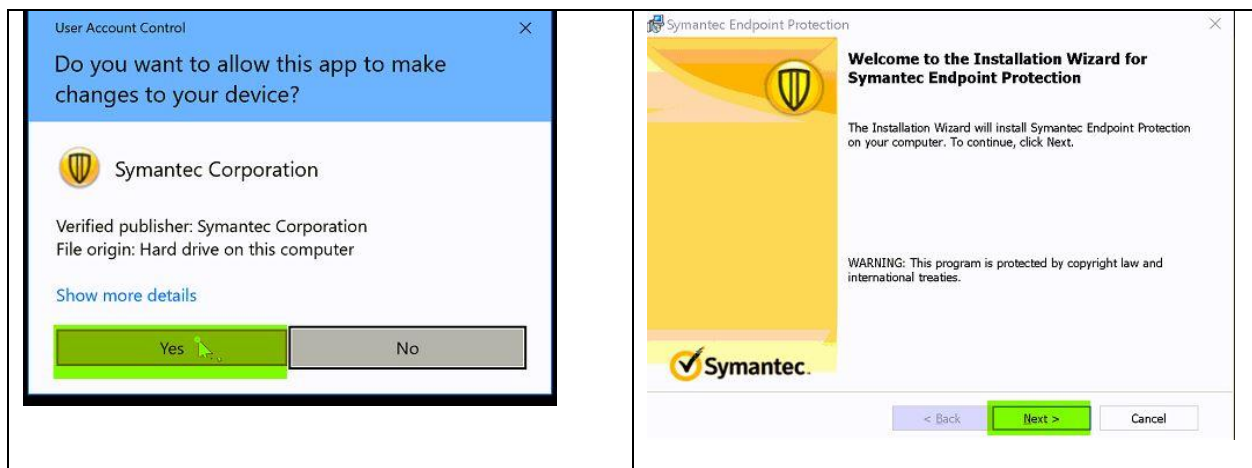

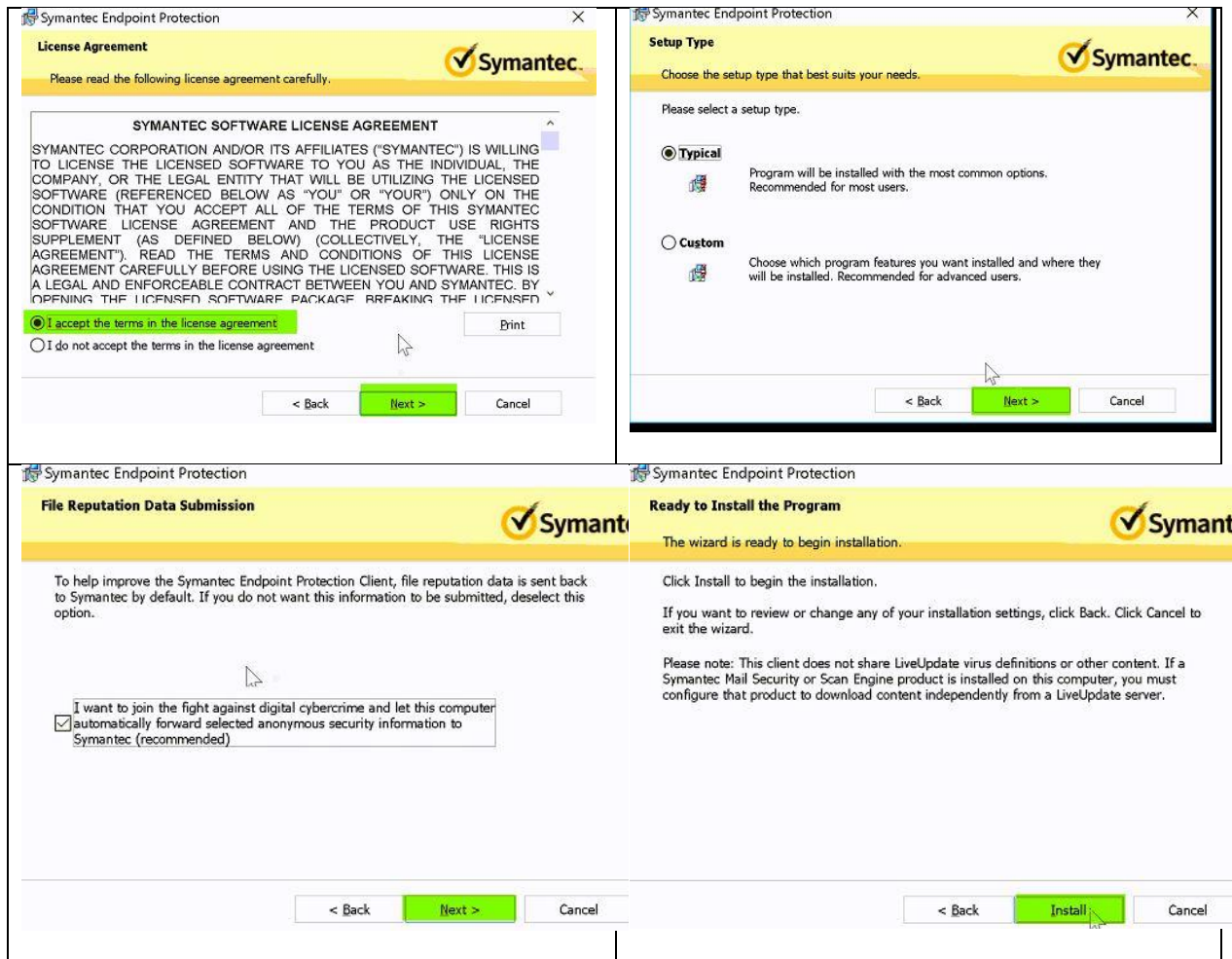

Once the install has completed, you will click Finish and then wait for SEP to update its files. When it finishes the update, it will demand a Restart of the computer.